

Essentials accessories



Scraper

Ref. product : VO147



Cutter

Ref. product : VO101



**Isopropyl
alcohol**

Ref. product : VO187

Installation kit for wall coverings (walls and furniture)

Ref. product : **VO216**



2 persons
recommended
for installation

Note : Luminis Films decorative adhesive coating can be applied to any smooth, non-porous surface. If in doubt, carry out a compatibility test with a sample and wait 1 to 2 weeks.

1 Preparation



1. Clean thoroughly

The surface must be free of dust or residue and degreased, using isopropyl alcohol and a micro-fibre cloth. Make sure the surface is dry.



2. Prepare the coating

Peel off 10 cm of the protective film. Then fold it over.



Use 2 pieces of tape (not supplied) placed at an angle opposite each other to separate the 2 parts.

i If you buy by the linear metre: pre-cut the covering, adding a 5 cm margin. Allow extra space if you want to fit the edges of the backing.

2 Application

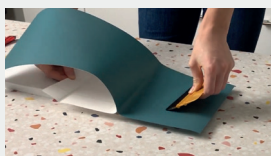

3. Apply the coating

Apply the coating to the upper part, working gradually from the inside out. Remove the protective film as you go.

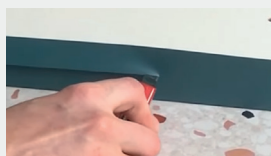

4. Re-cut if necessary



For a clean cut, angle your cutter blade at 45°.



Don't forget to use a clean, new cutter blade

3 Finition

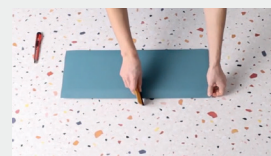

5. Scrape tighter

Scrape one last time, applying greater pressure.



To complete the activation of the adhesive, heat the coating using a heat gun.

The installation is complete !

Accessories recommended



Hair
dryer

ou



Heat
gun



**Primer
for adhesion**

Ref. product : VO213



Tips

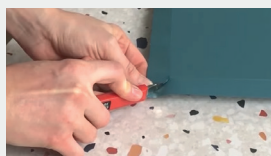

Covering a corner

Apply the covering to the flat surface, then cut diagonally across the corner, folding in the sides.



To improve adhesion, you can use an adhesion primer on these areas.



Making a connection

Make the joint by overlapping the 2 panels by 1 cm.

