

i Precautions: The application is done on the frame of the glass (never put directly on the glass). For the dimensions, take 3 cm more than the glass in width and height.

1 Preparing the film

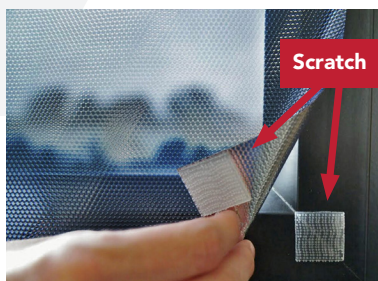

Apply scratch pads to the corners and edges of the film.

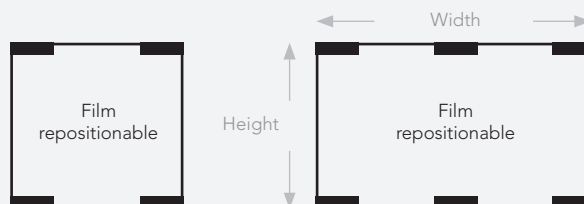

2 Positioning the film

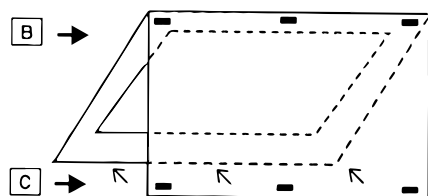

Remove the scratch guard from the top of the film and carefully apply it to the top of the frame [B]. Then do the same on the lower part [C].

3 Finish the installation

If necessary, unclip one or more scratch strips to adjust the film so that it does not ripple. The film should be as tight as possible.

Advice Luminis Films

- For vertical walls: put a scratch every 50 cm.
- For sloping walls (e.g. veranda roofs or velux windows): put a scratch every 30 cm.

Apply the scratches to the film and allow the adhesive to cure for at least 24 hours on the substrate before hanging the film.

 **The installation is complete !**

