

Essentials accessories



Scraper

Ref. product : VO147



Cutter

Ref. product : VO101



Isopropyl alcohol

Ref. product : VO187

Installation kit for wall coverings (walls and furniture)

Ref. product : **VO216**

i Note : Luminis Films decorative adhesive coating can be applied to any smooth, non-porous surface. If in doubt, carry out a compatibility test with a sample and wait 1 to 2 weeks.

1 Preparation



1. Clean thoroughly

The surface must be free of dust or residue and degreased, using isopropyl alcohol and a micro-fibre cloth. Make sure the surface is dry.



2. Prepare the coating

Peel off 10 cm of the protective film. Then fold it over.

💡 Use 2 pieces of tape (not supplied) placed at an angle opposite each other to separate the 2 parts.

i If you buy by the linear metre: pre-cut the covering, adding a 5 cm margin. Allow extra space if you want to fit the edges of the backing.

2 Application

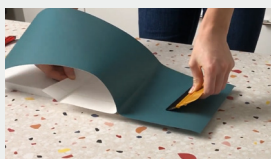

3. Apply the coating

Apply the coating to the upper part, working gradually from the inside out. Remove the protective film as you go.

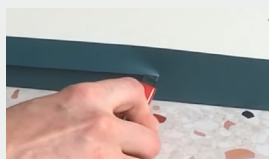

4. Re-cut if necessary

💡 For a clean cut, angle your cutter blade at 45°.

i Don't forget to use a clean, new cutter blade

3 Finition



5. Scrape tighter

Scrape one last time, applying greater pressure.

💡 To complete the activation of the adhesive, heat the coating using a heat gun.

👍 The installation is complete !

Accessories recommended



Hair dryer

ou



Heat gun



Primer for adhesion

Ref. product : VO213

💡 Tips

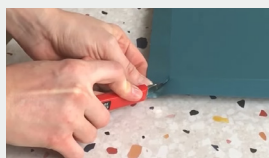

Covering a corner

Apply the covering to the flat surface, then cut diagonally across the corner, folding in the sides.

💡 To improve adhesion, you can use an adhesion primer on these areas.

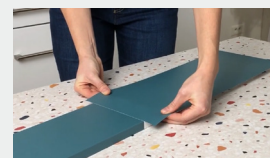

Making a connection

Make the joint by overlapping the 2 panels by 1 cm.

